

WEST SUSSEX COUNTY COUNCIL  
((ARUN DISTRICT) (PARKING PLACES & TRAFFIC REGULATION)  
(CONSOLIDATION) ORDER 2010)  
(EASTERN ARUN: VARIOUS PARISHES)  
(VARIOUS ROADS: SCHOOL KEEP CLEAR MARKINGS & PARKING REVIEW AMENDMENT)  
ORDER 2017

VARIOUS PARISHES: LOCATION OF WAITING RESTRICTIONS

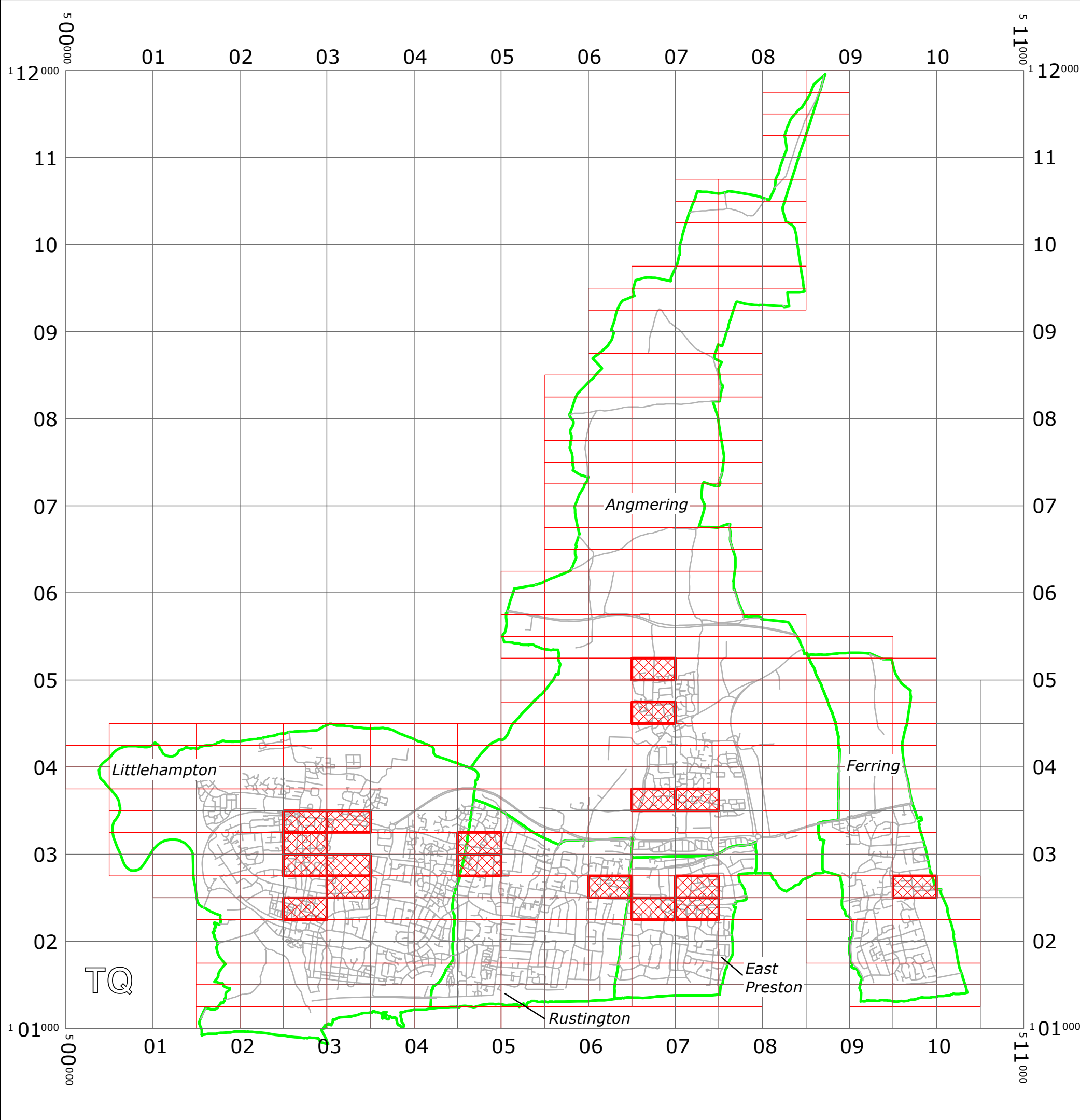

KEY:

- OS.TILE GRID
- PARKING TILE GRID
- LOCATION OF WAITING RESTRICTIONS
- PARISH BOUNDARY
- ROAD NETWORK



West Sussex County Council  
Highways & Transport  
The Grange  
Tower Street  
Chichester  
West Sussex  
PO19 1RH

WEST SUSSEX COUNTY COUNCIL  
((ARUN DISTRICT) (PARKING PLACES & TRAFFIC REGULATION)  
(CONSOLIDATION) ORDER 2010)  
(EASTERN ARUN: VARIOUS PARISHES) (VARIOUS ROADS:  
SCHOOL KEEP CLEAR MARKINGS & PARKING REVIEW  
AMENDMENT) ORDER 2017  
LOCATION OF WAITING RESTRICTIONS





Reproduced from or based upon 2017 Ordnance Survey mapping with permission of the Controller of HMSO (c) Crown Copyright reserved.  
Unauthorised reproduction infringes Crown copyright and may lead to prosecution or civil proceedings  
West Sussex County Council Licence No. 100023447

SCALE: 1:45000  
DATE: 10/04/2017

Key for Waiting Restrictions

All areas over which the provision of the orders apply are defined by the shaded areas as shown on the following plans plus a contiguous area not indicated on the plans of verge and/or footway between the carriageway edge and the highway boundary. The plans in this schedule are based upon grid references of the Ordnance Survey National Grid defined by the OSGB 36 triangulation.

Prohibition of waiting at any time

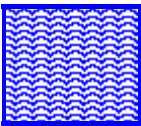
100		z_circle	No waiting, loading and unloading at any time
101		check	No waiting at any time
105		smallwave2	No waiting 8.00am-6.00pm any day

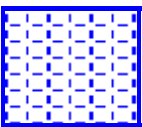
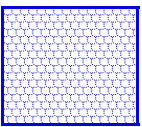
107		pat020	No waiting 8.00am-6.00pm Mon–Sat
140		shingle	No waiting 8.00am-10.00am, 2.00pm-4.00pm Mon-Fri

Prohibition of loading

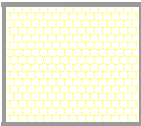
222		shingle	No waiting, loading and unloading 8.30am-9.15am and 2.45pm-4.00pm Mon-Fri except bank and public holidays
-----	---	---------	---

Free Limited Waiting

712		pat062	Waiting limited to 2hrs No return within 2hrs 8.00am-6.00pm Mon–Sat
716		shd62	Waiting limited to 1hr No return within 1hr 8.00am-6.00pm Mon–Sat

Specified Vehicles

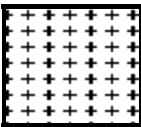
807		tic2	Parking place reserved for buses only 8.00am-5.00pm Mon-Fri
-----	---	------	--

Clearways (yellow 255-255-0)

1102		pat062	24hr Rural Clearway	1110		usgs677	School Keep Clear No stopping 8.00am-5.00pm Mon-Fri
1104		usgs620	Bus stop clearway 7.00am-7.00pm any day	1111		gravel	School Keep Clear No stopping 8.00am-4.00pm Mon-Fri

**WEST SUSSEX COUNTY COUNCIL**  
**((ARUN DISTRICT) (PARKING PLACES & TRAFFIC REGULATION)**  
**(CONSOLIDATION) ORDER 2010)**

**(EASTERN ARUN: VARIOUS PARISHES) (VARIOUS ROADS: SCHOOL KEEP**  
**CLEAR MARKINGS & PARKING REVIEW AMENDMENT) ORDER 2017**

West Sussex County Council in exercise of their powers under Sections 1 (1) 2 (1) and (2), 4 (2), 45, 46, 49 and 53 and Part IV of Schedule 9 of the Road Traffic Regulation Act 1984 ("the Act") as amended and of all other enabling powers and after consultation with the Chief Officer of Police in accordance with Part III of Schedule 9 to the Act hereby make the following Order:-

1. This Order shall come into operation on the Tenth day of April 2017 and may be cited as "West Sussex County Council ((Arun District) (Parking Places & Traffic Regulation) (Consolidation) Order 2010) (Eastern Arun: Various Parishes) (Various Roads: School Keep Clear Markings & Parking Review Amendment) Order 2017".
2. The "West Sussex County Council (Arun District) (Parking Places & Traffic Regulation) (Consolidation) Order 2010" is hereby amended by the replacement of the plans specified in the First Schedule to this Order, with the plans specified in the Second Schedule, attached hereto.
3. The "West Sussex County Council (Arun District) (Parking Places & Traffic Regulation) (Consolidation) Order 2010" is hereby amended by the insertion of the plans specified in the Third Schedule to this Order, attached hereto.

**FIRST SCHEDULE**  
**Plans to be Replaced**

TQ0202NEN (Issue Number 1)  
 TQ0202SEN (Issue Number 1)  
 TQ0203SEN (Issue Number 2)  
 TQ0203SES (Issue Number 1)  
 TQ0302NWS (Issue Number 1)  
 TQ0402NEN (Issue Number 2)  
 TQ0403SES (Issue Number 1)  
 TQ0602NWS (Issue Number 2)  
 TQ0603NES (Issue Number 2)  
 TQ0604NES (Issue Number 1)  
 TQ0605SES (Issue Number 2)  
 TQ0702SWN (Issue Number 2)  
 TQ0703NWS (Issue Number 1)

**SECOND SCHEDULE**  
**Replacement Plans**

TQ0202NEN (Issue Number 2)  
TQ0202SEN (Issue Number 2)  
TQ0203SEN (Issue Number 3)  
TQ0203SES (Issue Number 2)  
TQ0302NWS (Issue Number 2)  
TQ0402NEN (Issue Number 3)  
TQ0403SES (Issue Number 2)  
TQ0602NWS (Issue Number 3)  
TQ0603NES (Issue Number 3)  
TQ0604NES (Issue Number 2)  
TQ0605SES (Issue Number 3)  
TQ0702SWN (Issue Number 3)  
TQ0703NWS (Issue Number 2)

**THIRD SCHEDULE**  
**Plans to be Inserted**

TQ0302NWN (Issue Number 1)  
TQ0303SWN (Issue Number 1)  
TQ0602SEN (Issue Number 1)  
TQ0702NWS (Issue Number 1)  
TQ0902NES (Issue Number 1)

THE Common Seal of THE  
WEST SUSSEX COUNTY COUNCIL  
was hereto affixed the

day of <sup>SIXTH</sup> APRIL 2017

  
Authorised Signatory  
JWA8011-MM



04/08 DELEGATED AUTHORITY



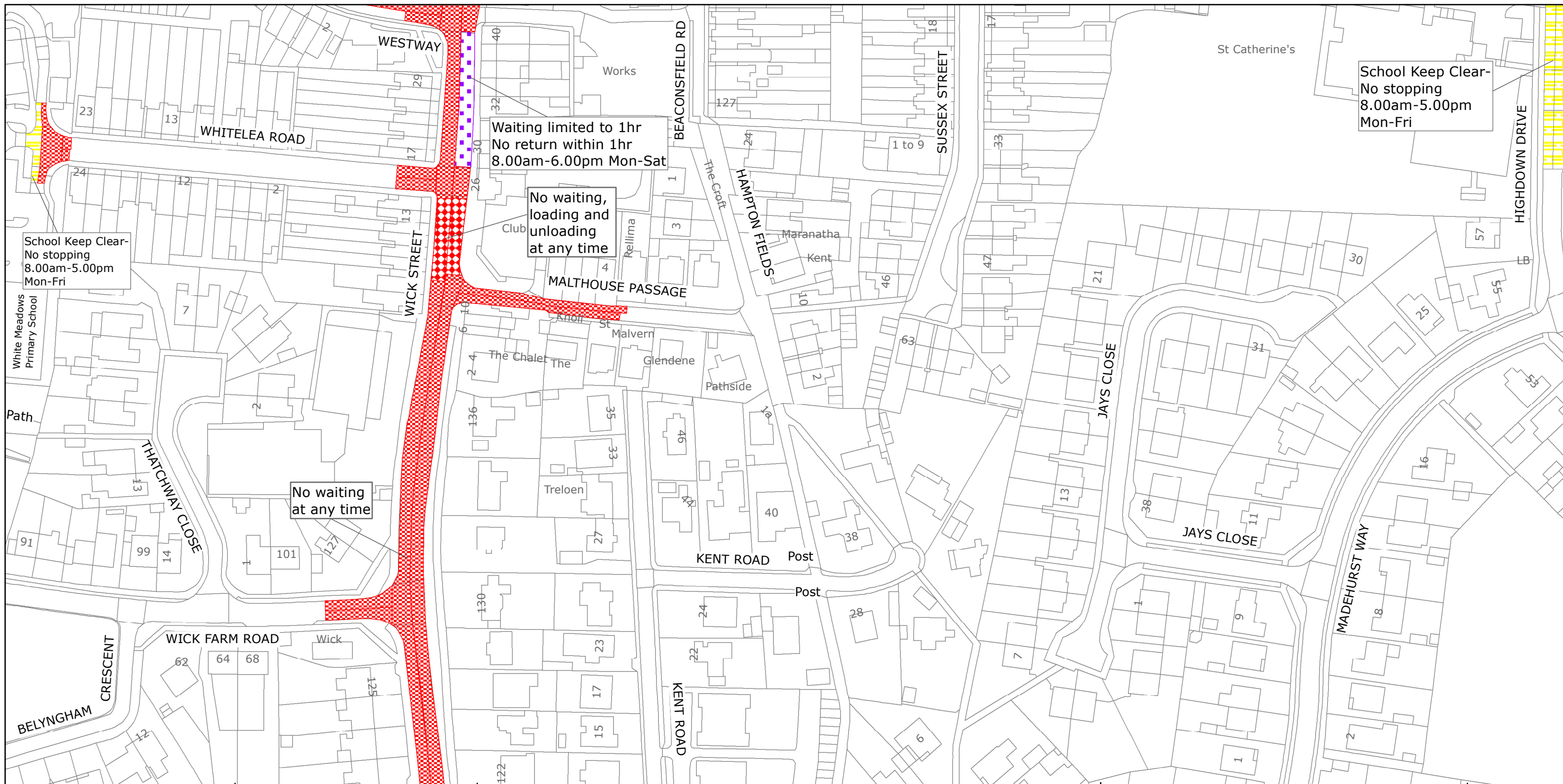

West Sussex County Council  
Highways & Transport  
The Grange  
Tower Street  
Chichester  
West Sussex  
PO19 1RH

ARUN DISTRICT: LITTLEHAMPTON  
WAITING RESTRICTIONS

Reproduced from or based upon 2017 Ordnance Survey mapping with permission of the Controller of HMSO (c) Crown Copyright reserved.  
Unauthorised reproduction infringes Crown copyright and may lead to prosecution or civil proceedings West Sussex County Council Licence No. 100018485

TILE REF NO:  
TQ0202NEN

SHEET ISSUE NO 2  
SHEET ACTIVE FROM - 10/04/2017



SCALE:  
1:1250  
at A3 size



West Sussex County Council  
Highways & Transport  
The Grange  
Tower Street  
Chichester  
West Sussex  
PO19 1RH

ARUN DISTRICT: LITTLEHAMPTON  
WAITING RESTRICTIONS

Reproduced from or based upon 2017 Ordnance Survey mapping with permission of the Controller of HMSO (c) Crown Copyright reserved.  
Unauthorised reproduction infringes Crown copyright and may lead to prosecution or civil proceedings West Sussex County Council Licence No. 100018485

TILE REF NO:  
TQ0202SEN

SHEET ISSUE NO 2  
SHEET ACTIVE FROM - 10/04/2017



SCALE:  
1:1250  
at A3 size



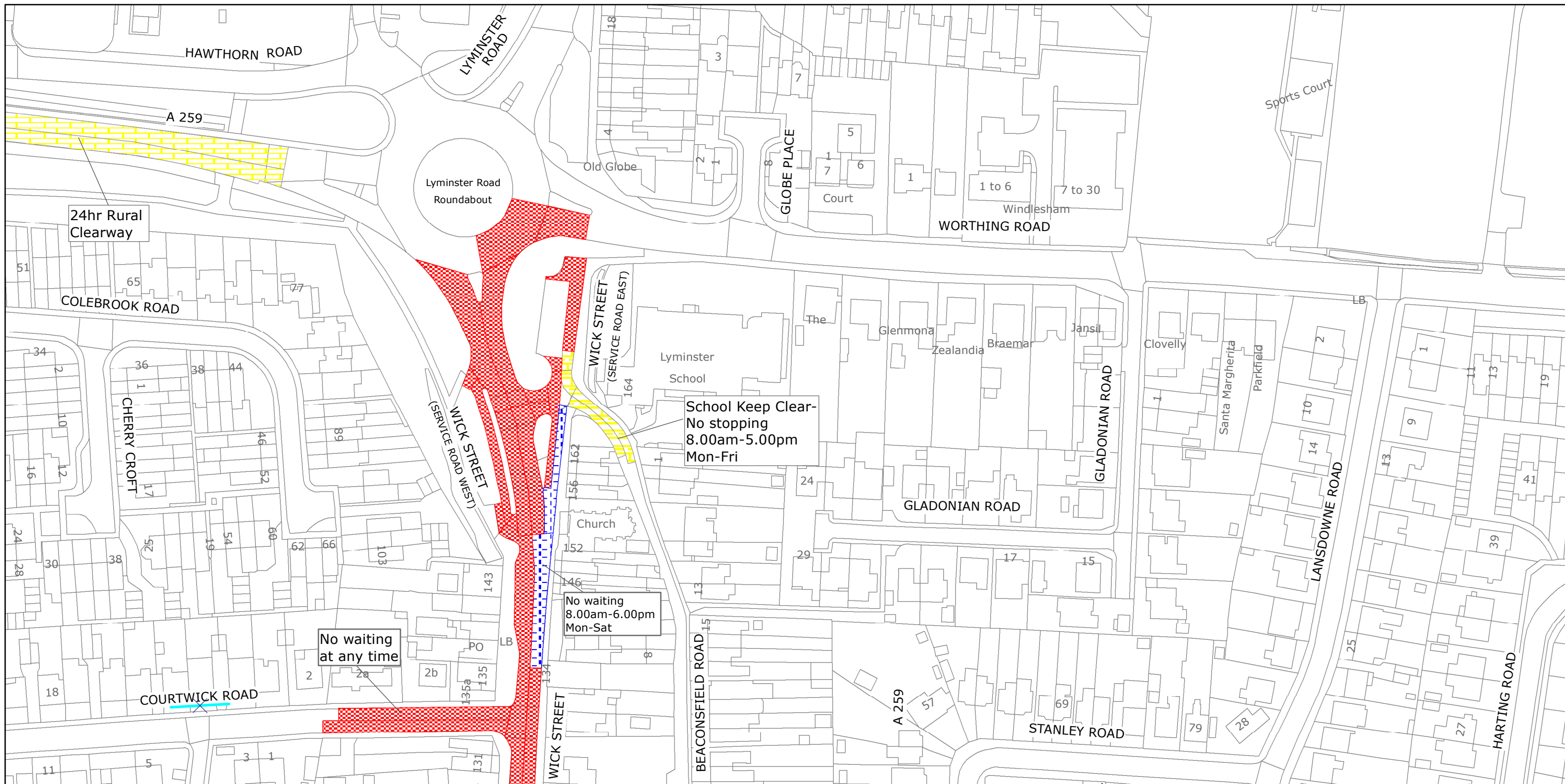

West Sussex County Council  
Highways & Transport  
The Grange  
Tower Street  
Chichester  
West Sussex  
PO19 1RH

ARUN DISTRICT: LITTLEHAMPTON  
WAITING RESTRICTIONS

Reproduced from or based upon 2017 Ordnance Survey mapping with permission of the Controller of HMSO (c) Crown Copyright reserved.  
Unauthorised reproduction infringes Crown copyright and may lead to prosecution or civil proceedings West Sussex County Council Licence No. 100018485

TILE REF NO:  
TQ0203SEN

SHEET ISSUE NO 3  
SHEET ACTIVE FROM - 10/04/2017



SCALE:  
1:1250  
at A3 size

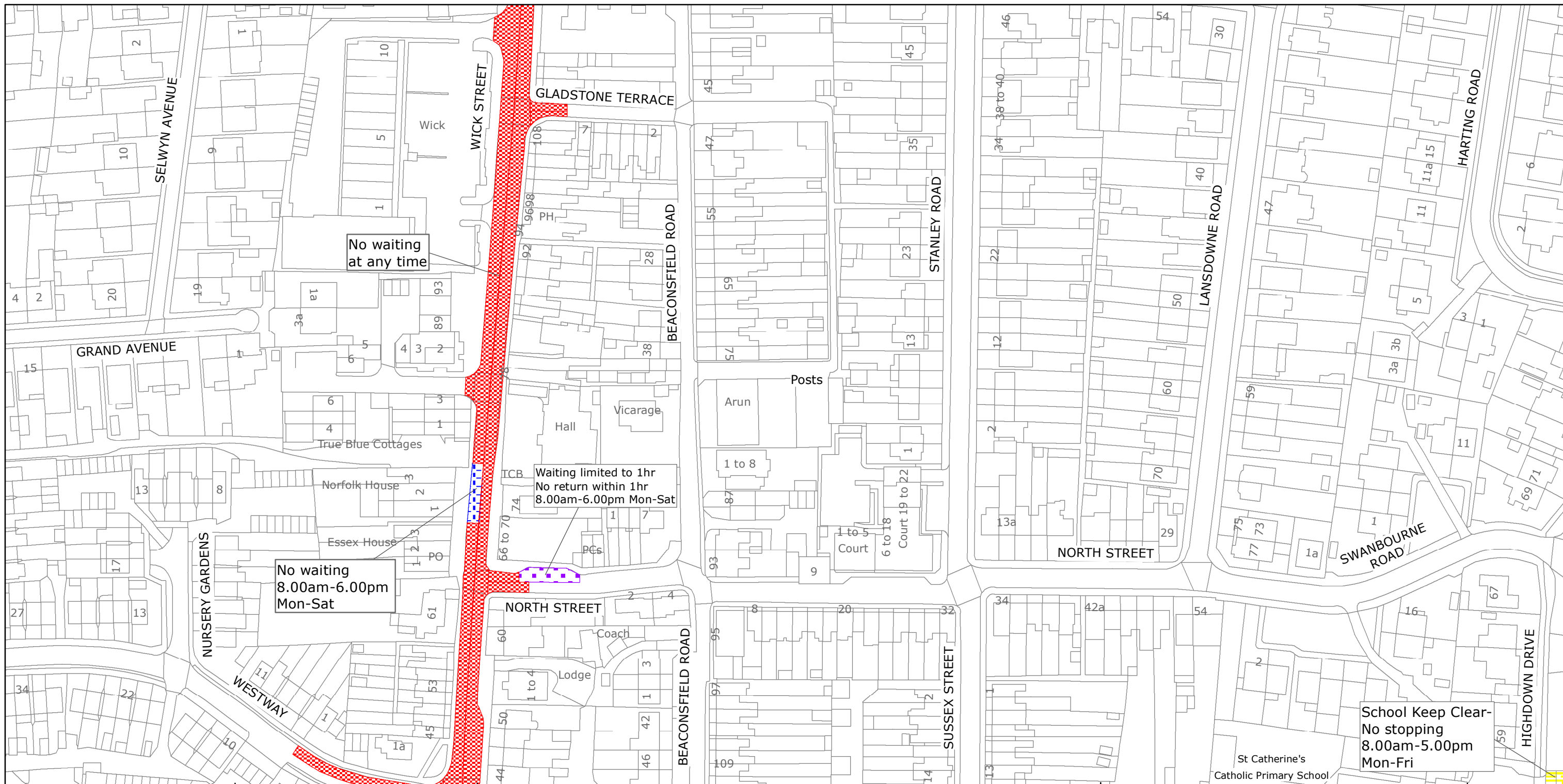

West Sussex County Council  
Highways & Transport  
The Grange  
Tower Street  
Chichester  
West Sussex  
PO19 1RH

ARUN DISTRICT: LITTLEHAMPTON

WAITING RESTRICTIONS

Reproduced from or based upon 2017 Ordnance Survey mapping with permission of the Controller of HMSO (c) Crown Copyright reserved.  
Unauthorised reproduction infringes Crown copyright and may lead to prosecution or civil proceedings West Sussex County Council Licence No. 100018485

TILE REF NO:  
TQ0203SES

SHEET ISSUE NO 2  
SHEET ACTIVE FROM - 10/04/2017



SCALE:  
1:1250  
at A3 size

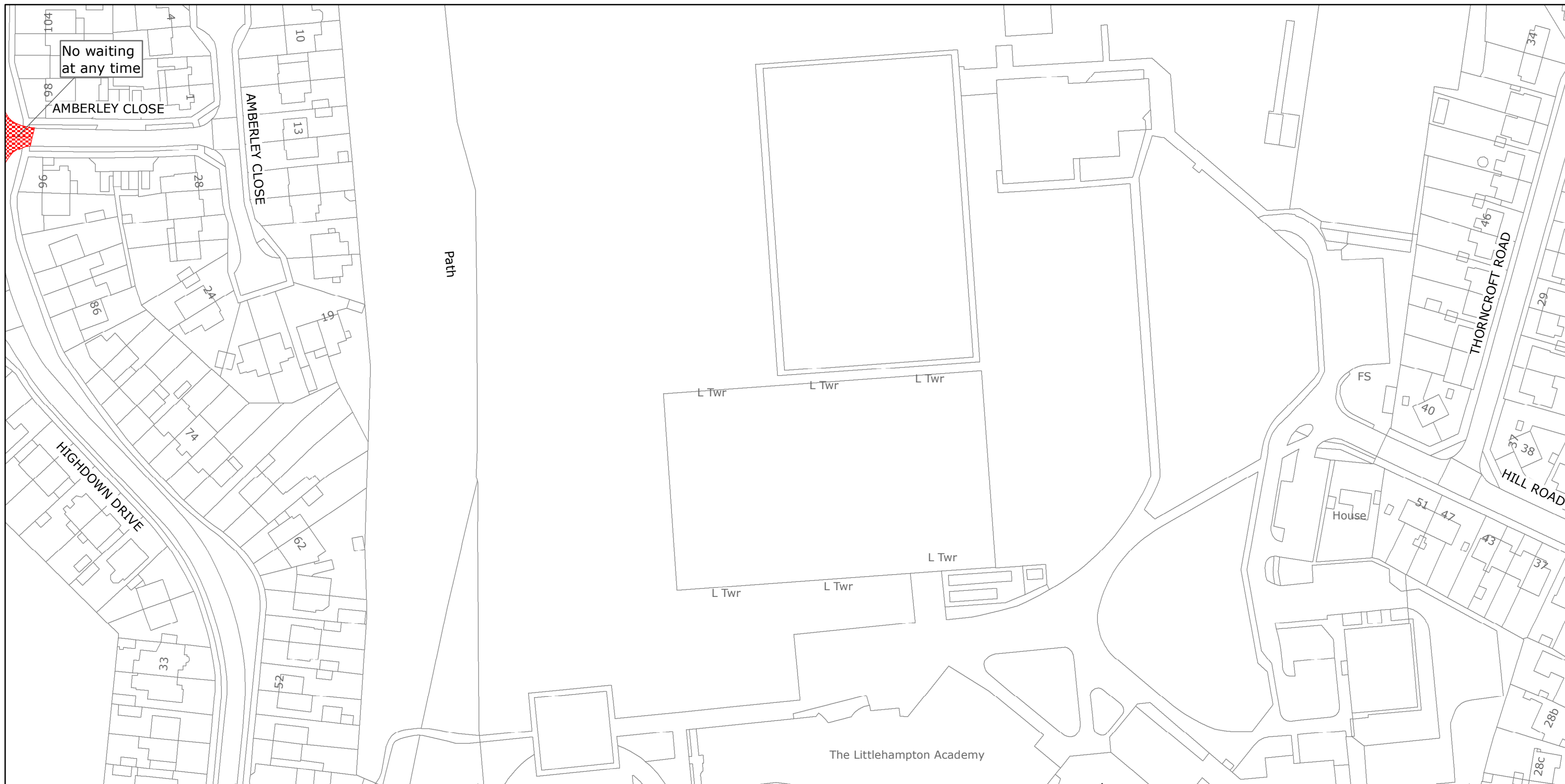

West Sussex County Council  
Highways & Transport  
The Grange  
Tower Street  
Chichester  
West Sussex  
PO19 1RH

ARUN DISTRICT: LITTLEHAMPTON

WAITING RESTRICTIONS

Reproduced from or based upon 2017 Ordnance Survey mapping with permission of the Controller of HMSO (c) Crown Copyright reserved.  
Unauthorised reproduction infringes Crown copyright and may lead to prosecution or civil proceedings West Sussex County Council Licence No. 100018485

TILE REF NO:  
TQ0302NWN

SHEET ISSUE NO 1  
SHEET ACTIVE FROM - 10/04/2017



SCALE:  
1:1250  
at A3 size



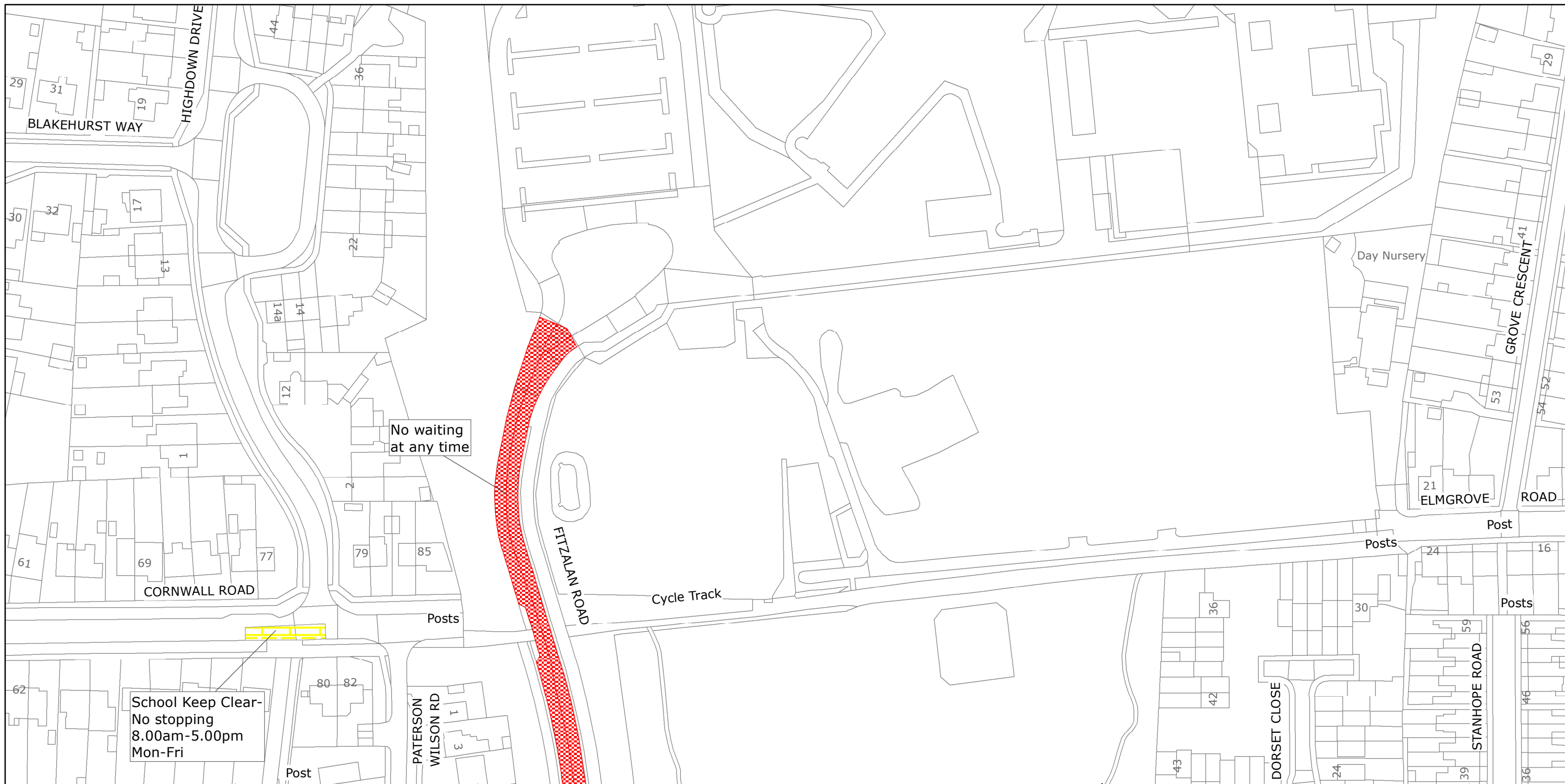

West Sussex County Council  
Highways & Transport  
The Grange  
Tower Street  
Chichester  
West Sussex  
PO19 1RH

## ARUN DISTRICT: LITTLEHAMPTON

### WAITING RESTRICTIONS

Reproduced from or based upon 2017 Ordnance Survey mapping with permission of the Controller of HMSO (c) Crown Copyright reserved.  
Unauthorised reproduction infringes Crown copyright and may lead to prosecution or civil proceedings West Sussex County Council Licence No. 100018485

# TILE REF NO: TQ0302NWS

SHEET ISSUE NO 2  
SHEET ACTIVE FROM - 10/04/2017



SCALE:  
1:1250  
at A3 size



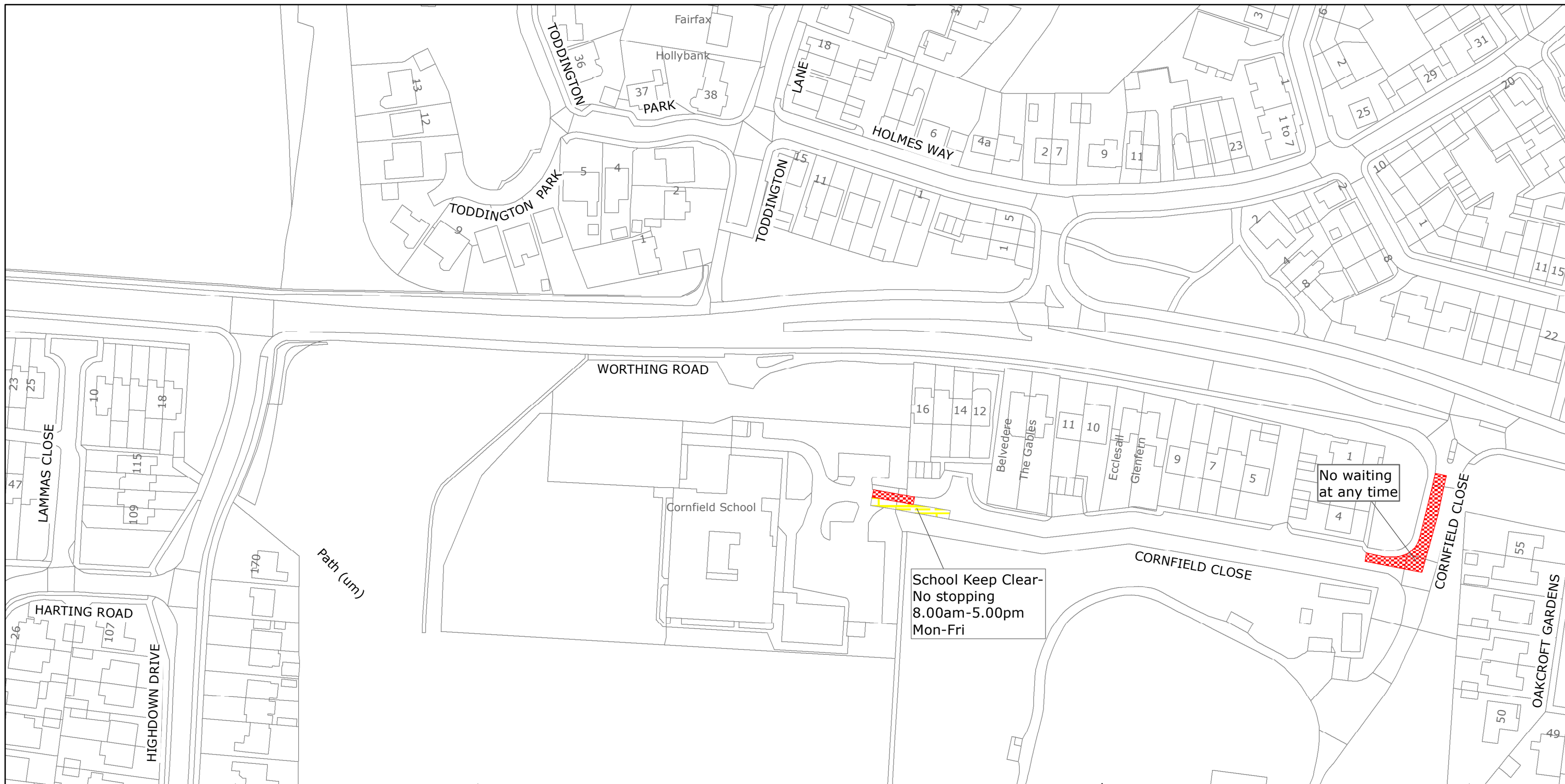

West Sussex County Council  
Highways & Transport  
The Grange  
Tower Street  
Chichester  
West Sussex  
PO19 1RH

## ARUN DISTRICT: LITTLEHAMPTON

### WAITING RESTRICTIONS

Reproduced from or based upon 2017 Ordnance Survey mapping with permission of the Controller of HMSO (c) Crown Copyright reserved.  
Unauthorised reproduction infringes Crown copyright and may lead to prosecution or civil proceedings West Sussex County Council Licence No. 100018485

## TILE REF NO: TQ0303SWN

SHEET ISSUE NO 1  
SHEET ACTIVE FROM - 10/04/2017



SCALE:  
1:1250  
at A3 size

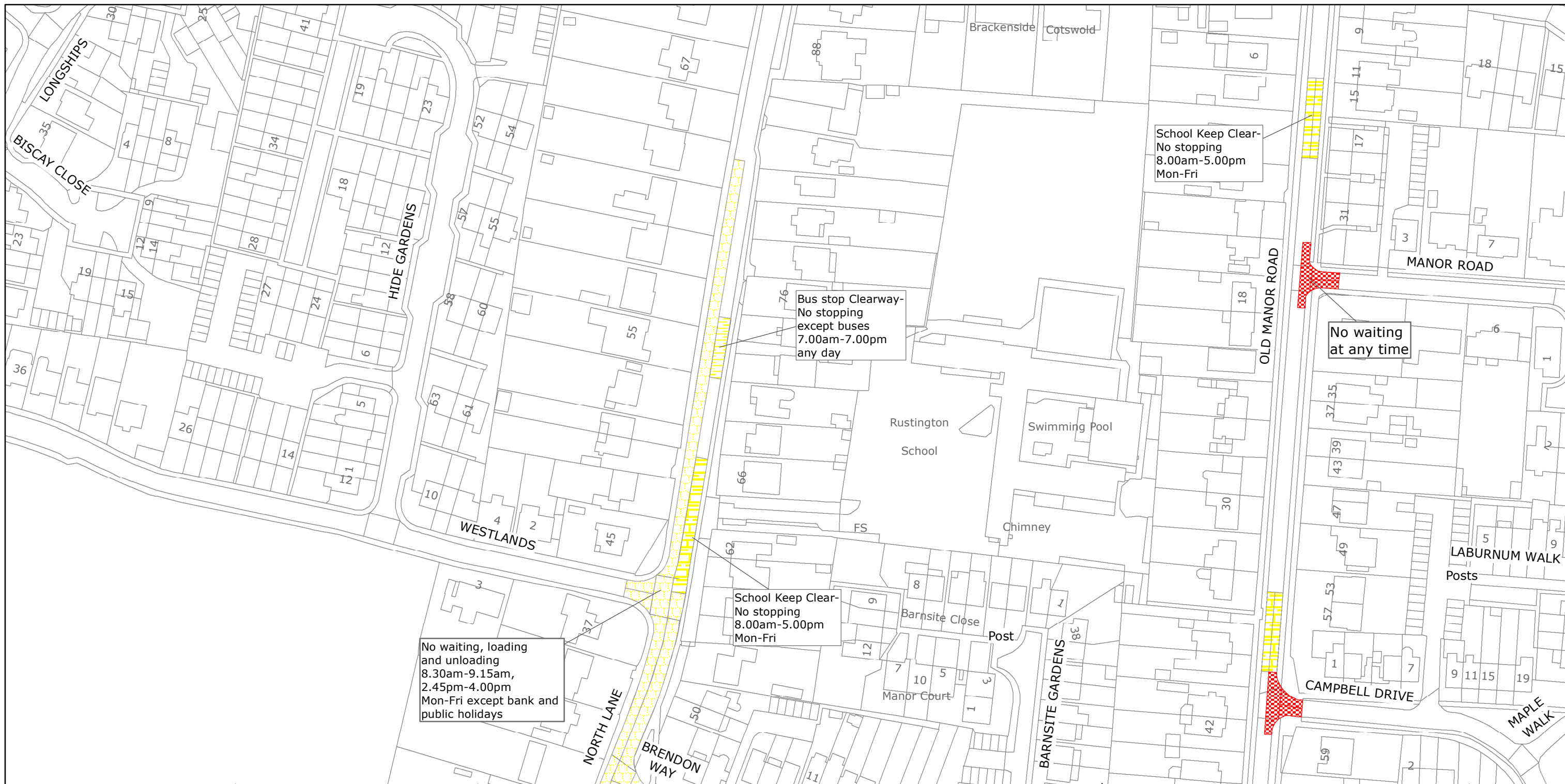

West Sussex County Council  
Highways & Transport  
The Grange  
Tower Street  
Chichester  
West Sussex  
PO19 1RH

ARUN DISTRICT: RUSTINGTON  
WAITING RESTRICTIONS

Reproduced from or based upon 2017 Ordnance Survey mapping with permission of the Controller of HMSO (c) Crown Copyright reserved.  
Unauthorised reproduction infringes Crown copyright and may lead to prosecution or civil proceedings West Sussex County Council Licence No. 100018485

TILE REF NO:  
TQ0402NEN

SHEET ISSUE NO 3  
SHEET ACTIVE FROM - 10/04/2017



SCALE:  
1:1250  
at A3 size



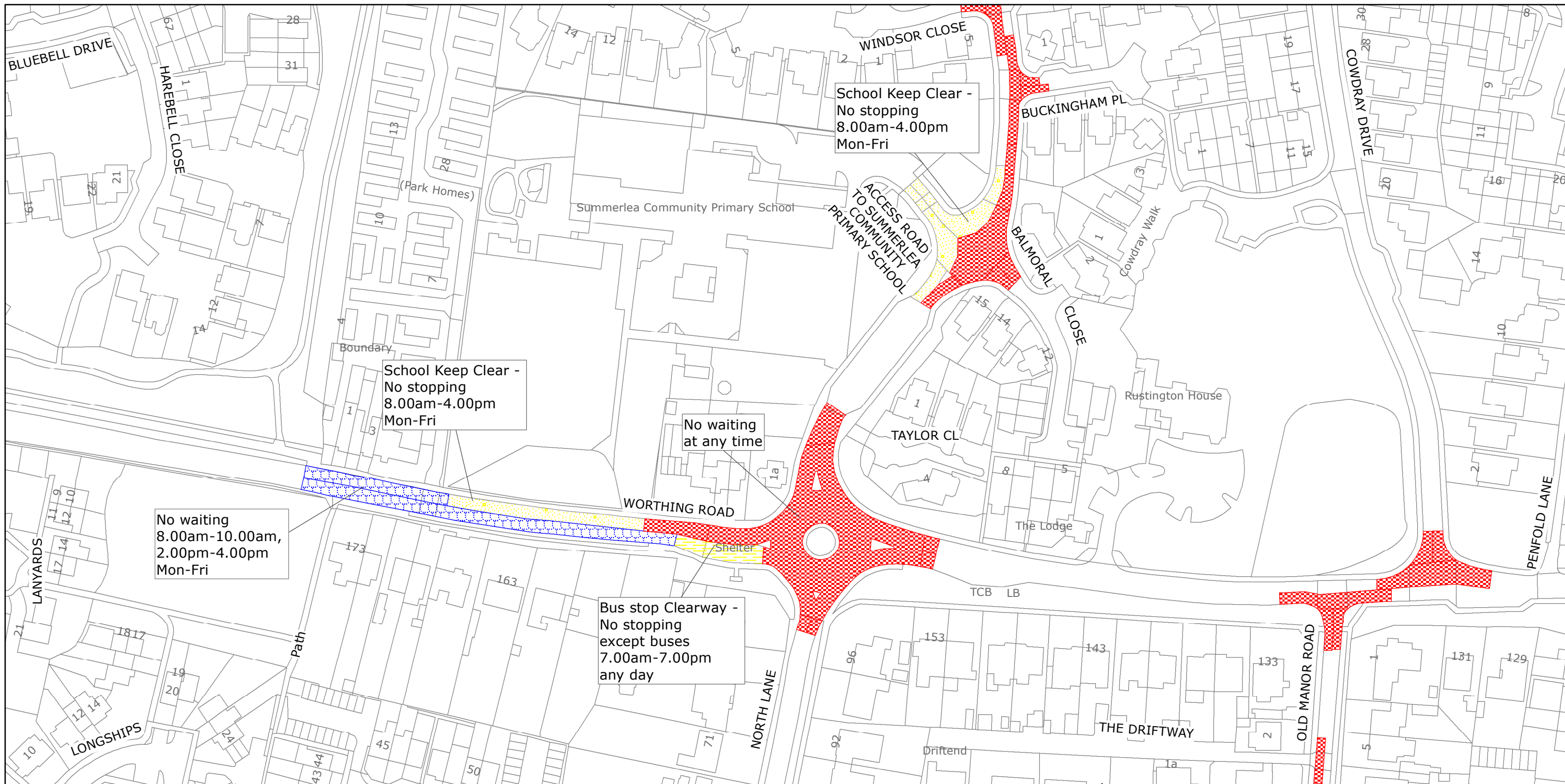

West Sussex County Council  
Highways & Transport  
The Grange  
Tower Street  
Chichester  
West Sussex  
PO19 1RH

ARUN DISTRICT: RUSTINGTON  
WAITING RESTRICTIONS

Reproduced from or based upon 2017 Ordnance Survey mapping with permission of the Controller of HMSO (c) Crown Copyright reserved.  
Unauthorised reproduction infringes Crown copyright and may lead to prosecution or civil proceedings West Sussex County Council Licence No. 100018485

TILE REF NO:  
TQ0403SES

SHEET ISSUE NO 2  
SHEET ACTIVE FROM - 10/04/2017



SCALE:  
1:1250  
at A3 size

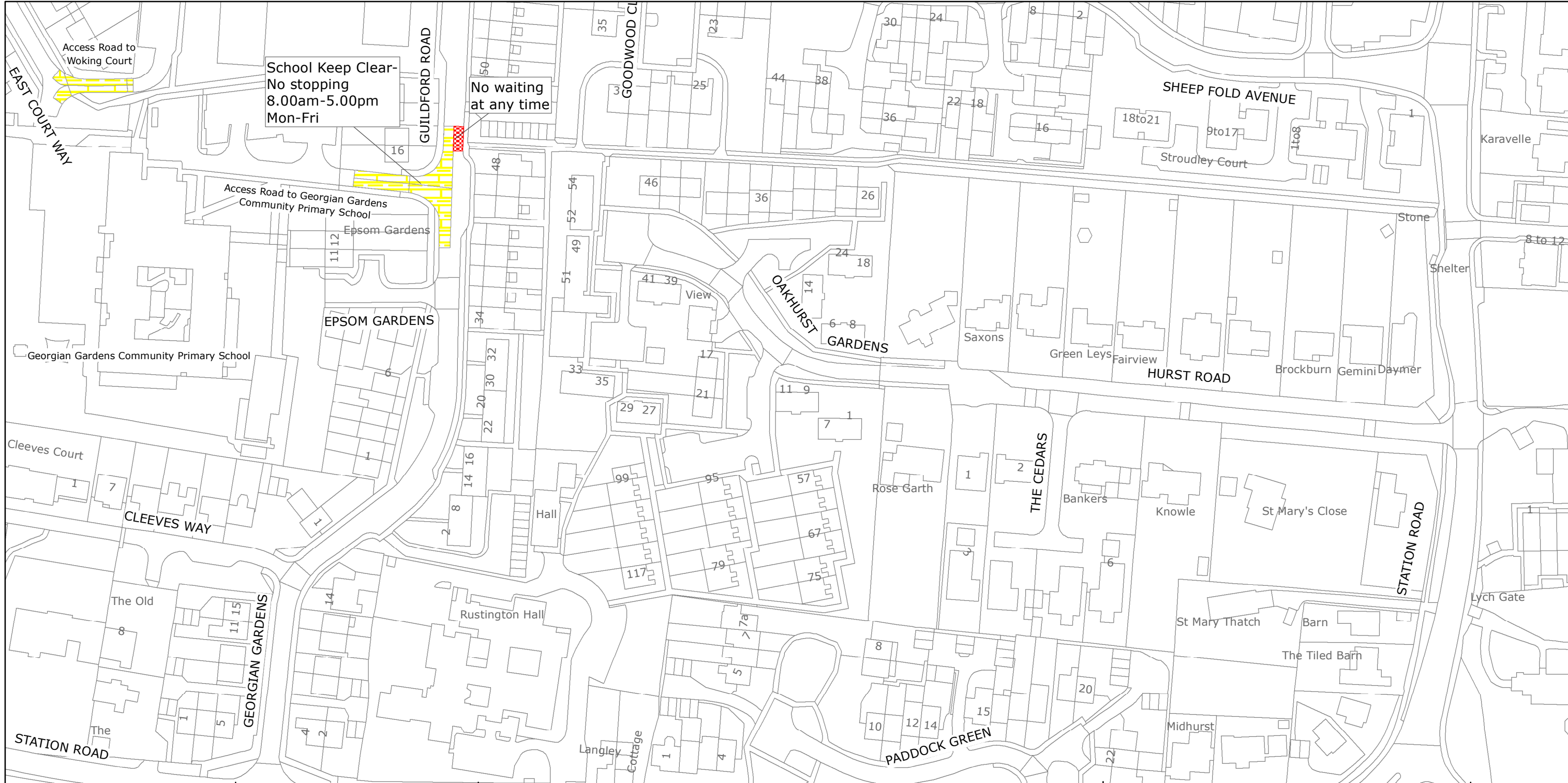

West Sussex County Council  
Highways & Transport  
The Grange  
Tower Street  
Chichester  
West Sussex  
PO19 1RH

ARUN DISTRICT: EAST PRESTON AND  
RUSTINGTON

WAITING RESTRICTIONS

Reproduced from or based upon 2017 Ordnance Survey mapping with permission of the Controller of HMSO (c) Crown Copyright reserved.  
Unauthorised reproduction infringes Crown copyright and may lead to prosecution or civil proceedings West Sussex County Council Licence No. 100018485

TILE REF NO:  
TQ0602NWS

SHEET ISSUE NO 3  
SHEET ACTIVE FROM - 10/04/2017



SCALE:  
1:1250  
at A3 size



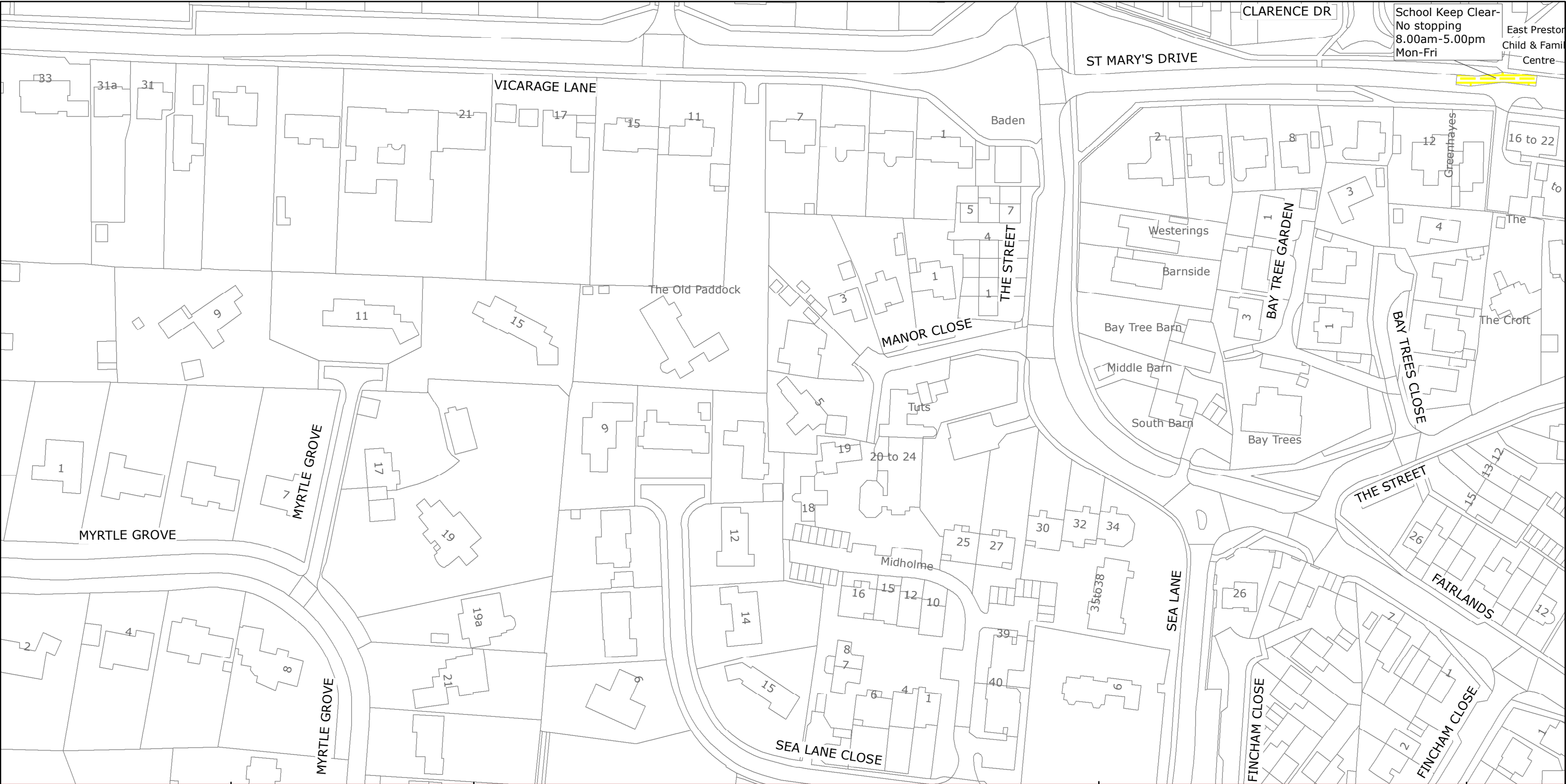

West Sussex County Council  
Highways & Transport  
The Grange  
Tower Street  
Chichester  
West Sussex  
PO19 1RH

Reproduced from or based upon 2017 Ordnance Survey mapping with permission of the Controller of HMSO (c) Crown Copyright reserved.  
Unauthorised reproduction infringes Crown copyright and may lead to prosecution or civil proceedings West Sussex County Council Licence No. 100018485

ARUN DISTRICT: EAST PRESTON  
WAITING RESTRICTIONS

TILE REF NO:  
TQ0602SEN

SHEET ISSUE NO 1  
SHEET ACTIVE FROM - 10/04/2017

N  
  
SCALE:  
1:1250  
at A3 size

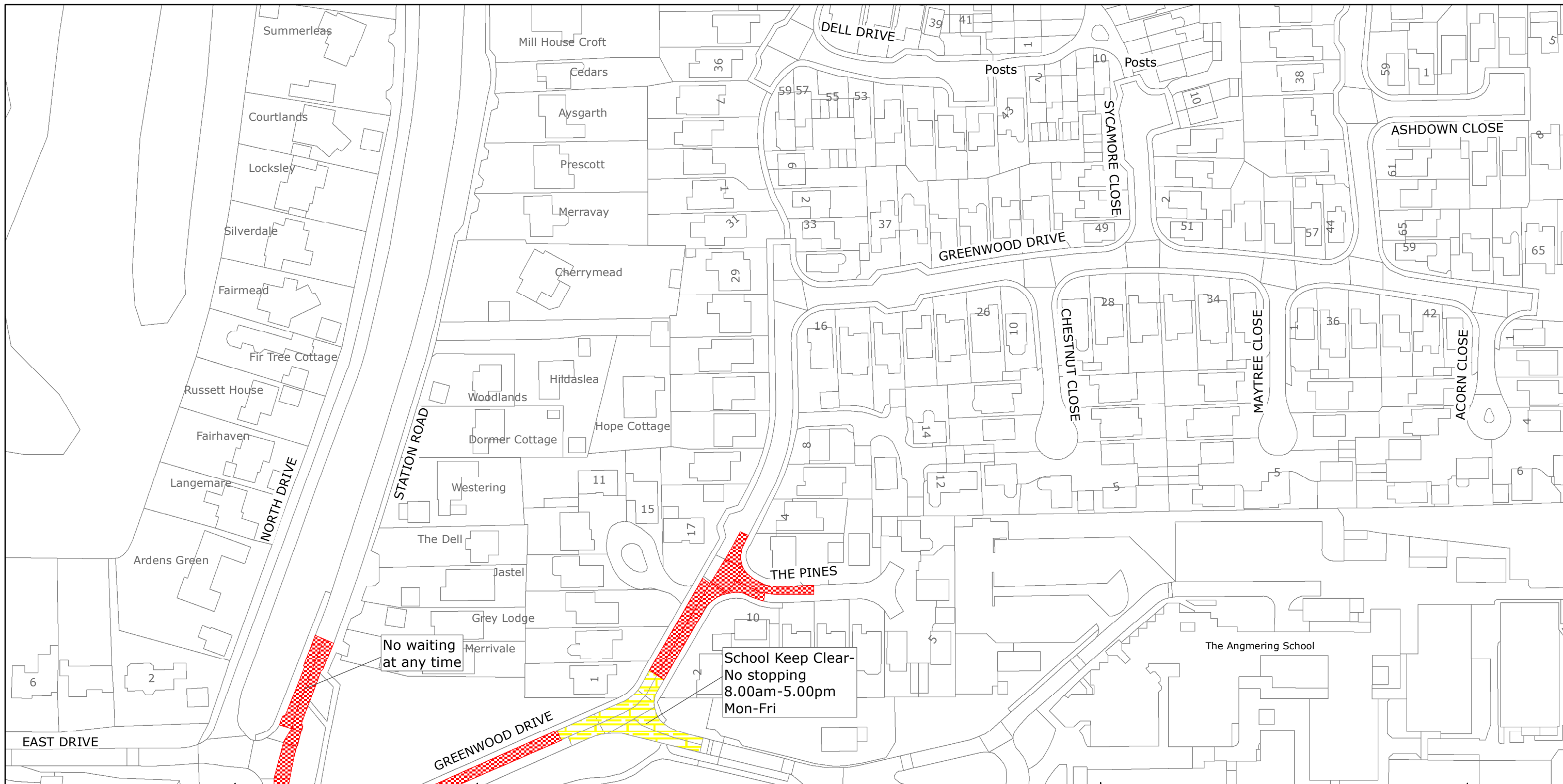

West Sussex County Council  
Highways & Transport  
The Grange  
Tower Street  
Chichester  
West Sussex  
PO19 1RH

## ARUN DISTRICT: ANGMERING

### WAITING RESTRICTIONS

Reproduced from or based upon 2017 Ordnance Survey mapping with permission of the Controller of HMSO (c) Crown Copyright reserved.  
Unauthorised reproduction infringes Crown copyright and may lead to prosecution or civil proceedings West Sussex County Council Licence No. 100018485

# TILE REF NO: TQ0603NES

SHEET ISSUE NO 3  
SHEET ACTIVE FROM - 10/04/2017



SCALE:  
1:1250  
at A3 size

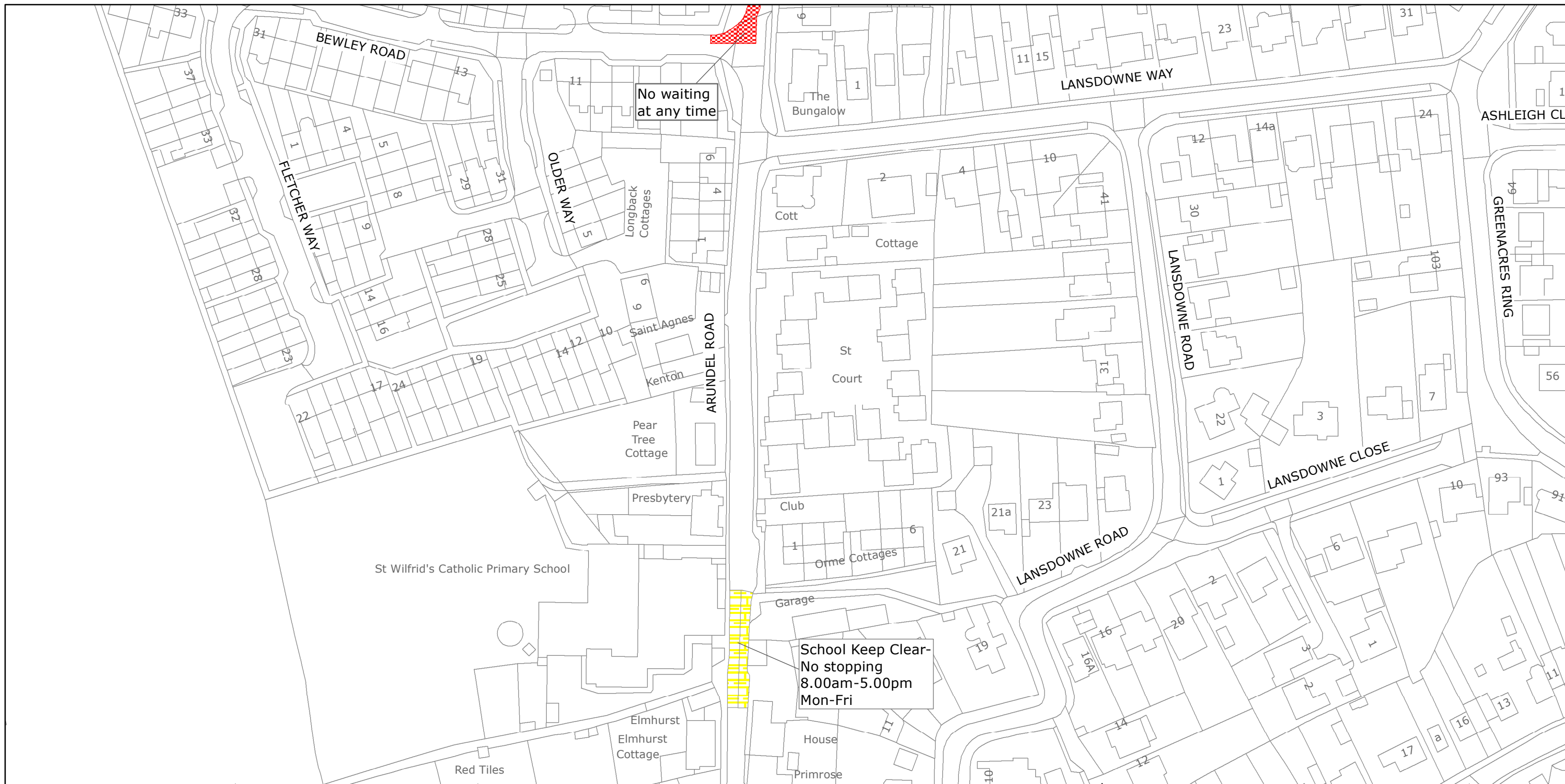

West Sussex County Council  
Highways & Transport  
The Grange  
Tower Street  
Chichester  
West Sussex  
PO19 1RH

## ARUN DISTRICT: ANGMERING

### WAITING RESTRICTIONS

Reproduced from or based upon 2017 Ordnance Survey mapping with permission of the Controller of HMSO (c) Crown Copyright reserved.  
Unauthorised reproduction infringes Crown copyright and may lead to prosecution or civil proceedings West Sussex County Council Licence No. 100018485

# TILE REF NO: TQ0604NES

SHEET ISSUE NO 2  
SHEET ACTIVE FROM - 10/04/2017



SCALE:  
1:1250  
at A3 size



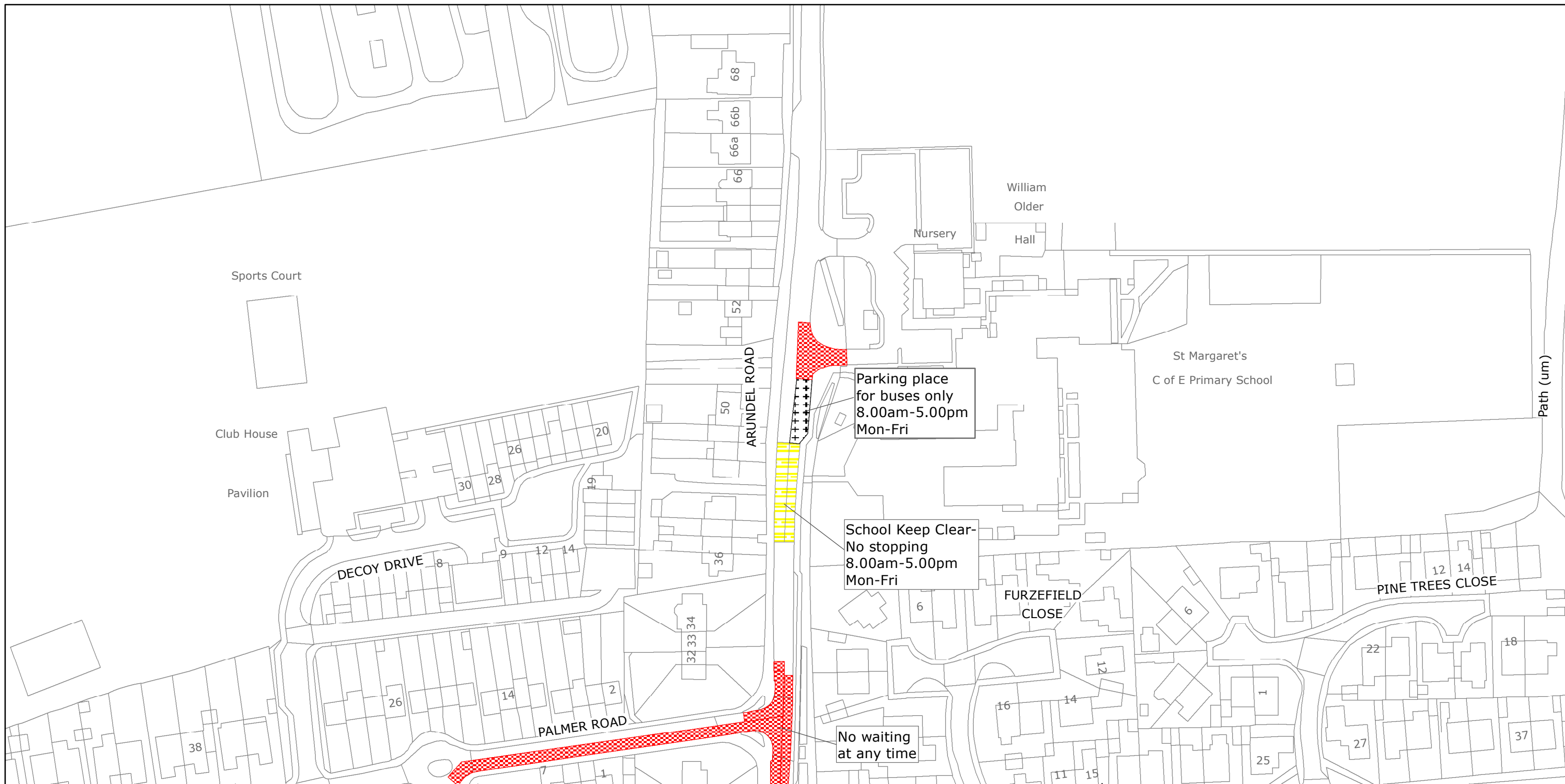

West Sussex County Council  
Highways & Transport  
The Grange  
Tower Street  
Chichester  
West Sussex  
PO19 1RH

## ARUN DISTRICT: ANGMERING

### WAITING RESTRICTIONS

Reproduced from or based upon 2017 Ordnance Survey mapping with permission of the Controller of HMSO (c) Crown Copyright reserved.  
Unauthorised reproduction infringes Crown copyright and may lead to prosecution or civil proceedings West Sussex County Council Licence No. 100018485

## TILE REF NO: TQ0605SES

SHEET ISSUE NO 3  
SHEET ACTIVE FROM - 10/04/2017



SCALE:  
1:1250  
at A3 size



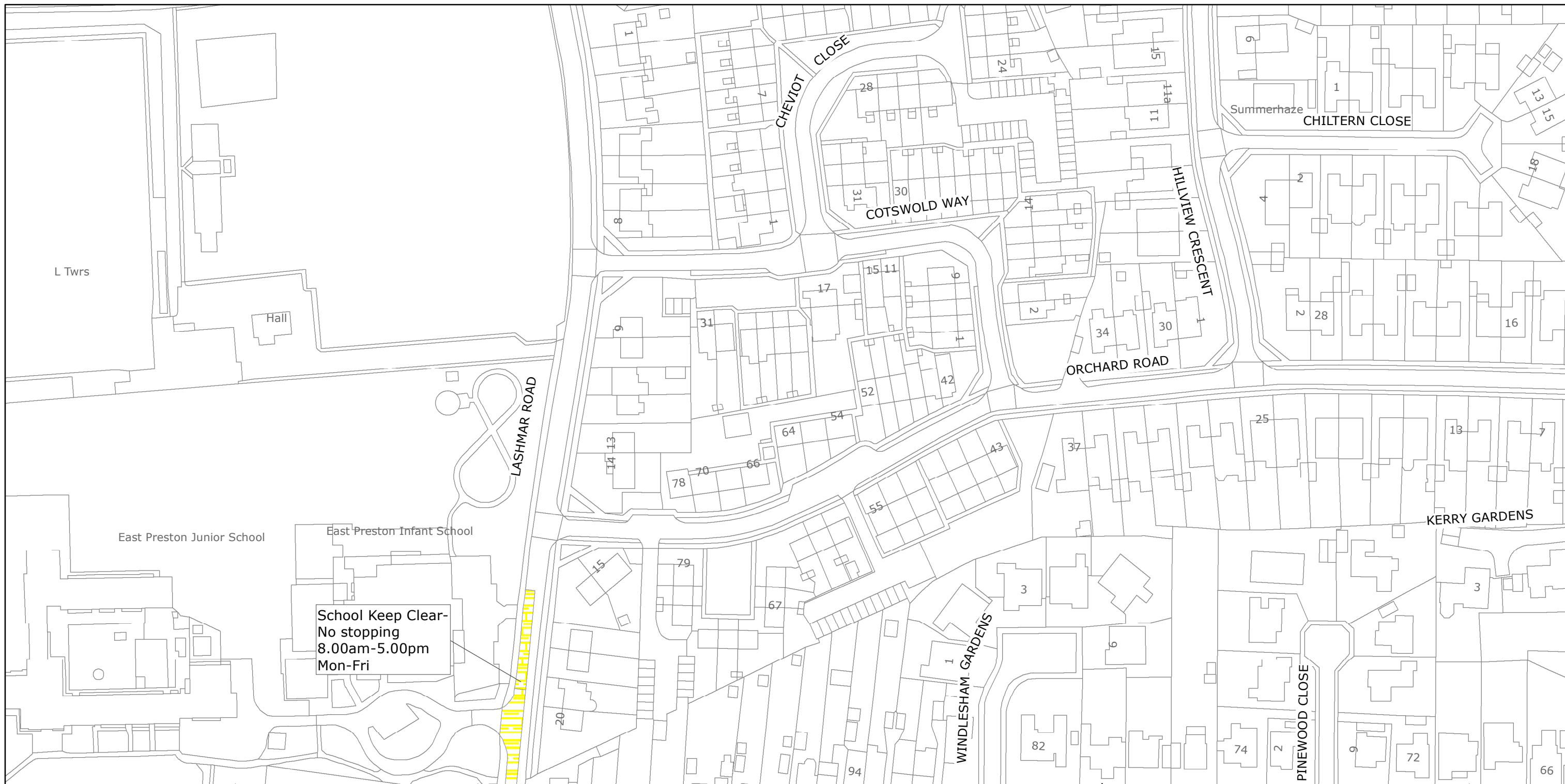

West Sussex County Council  
Highways & Transport  
The Grange  
Tower Street  
Chichester  
West Sussex  
PO19 1RH

ARUN DISTRICT: EAST PRESTON  
WAITING RESTRICTIONS

Reproduced from or based upon 2017 Ordnance Survey mapping with permission of the Controller of HMSO (c) Crown Copyright reserved.  
Unauthorised reproduction infringes Crown copyright and may lead to prosecution or civil proceedings West Sussex County Council Licence No. 100018485

TILE REF NO:  
TQ0702NWS

SHEET ISSUE NO 1  
SHEET ACTIVE FROM - 10/04/2017



SCALE:  
1:1250  
at A3 size

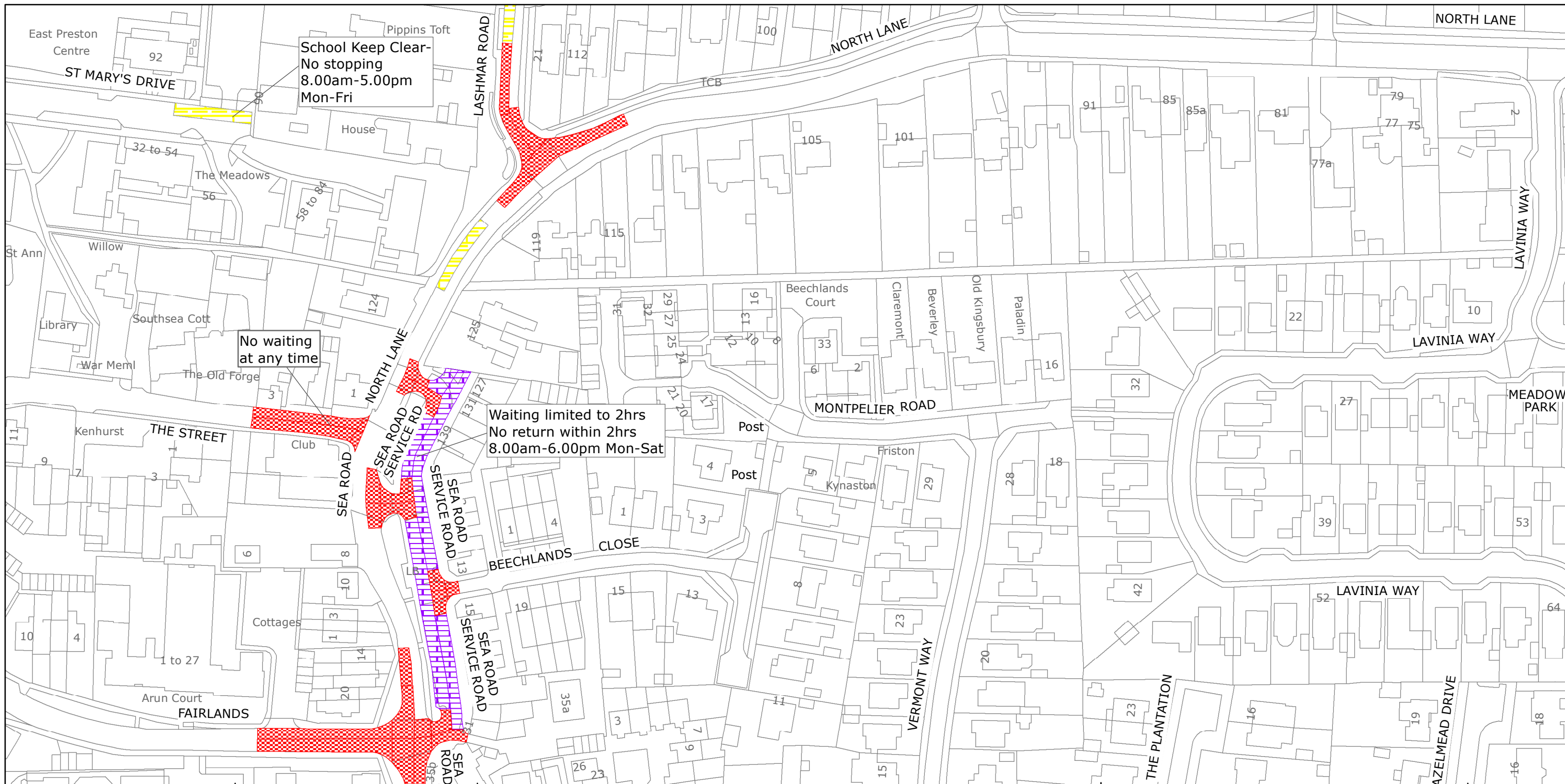

West Sussex County Council  
Highways & Transport  
The Grange  
Tower Street  
Chichester  
West Sussex  
PO19 1RH

ARUN DISTRICT: EAST PRESTON  
WAITING RESTRICTIONS

Reproduced from or based upon 2017 Ordnance Survey mapping with permission of the Controller of HMSO (c) Crown Copyright reserved.  
Unauthorised reproduction infringes Crown copyright and may lead to prosecution or civil proceedings West Sussex County Council Licence No. 100018485

TILE REF NO:  
TQ0702SWN

SHEET ISSUE NO 3  
SHEET ACTIVE FROM - 10/04/2017



SCALE:  
1:1250  
at A3 size

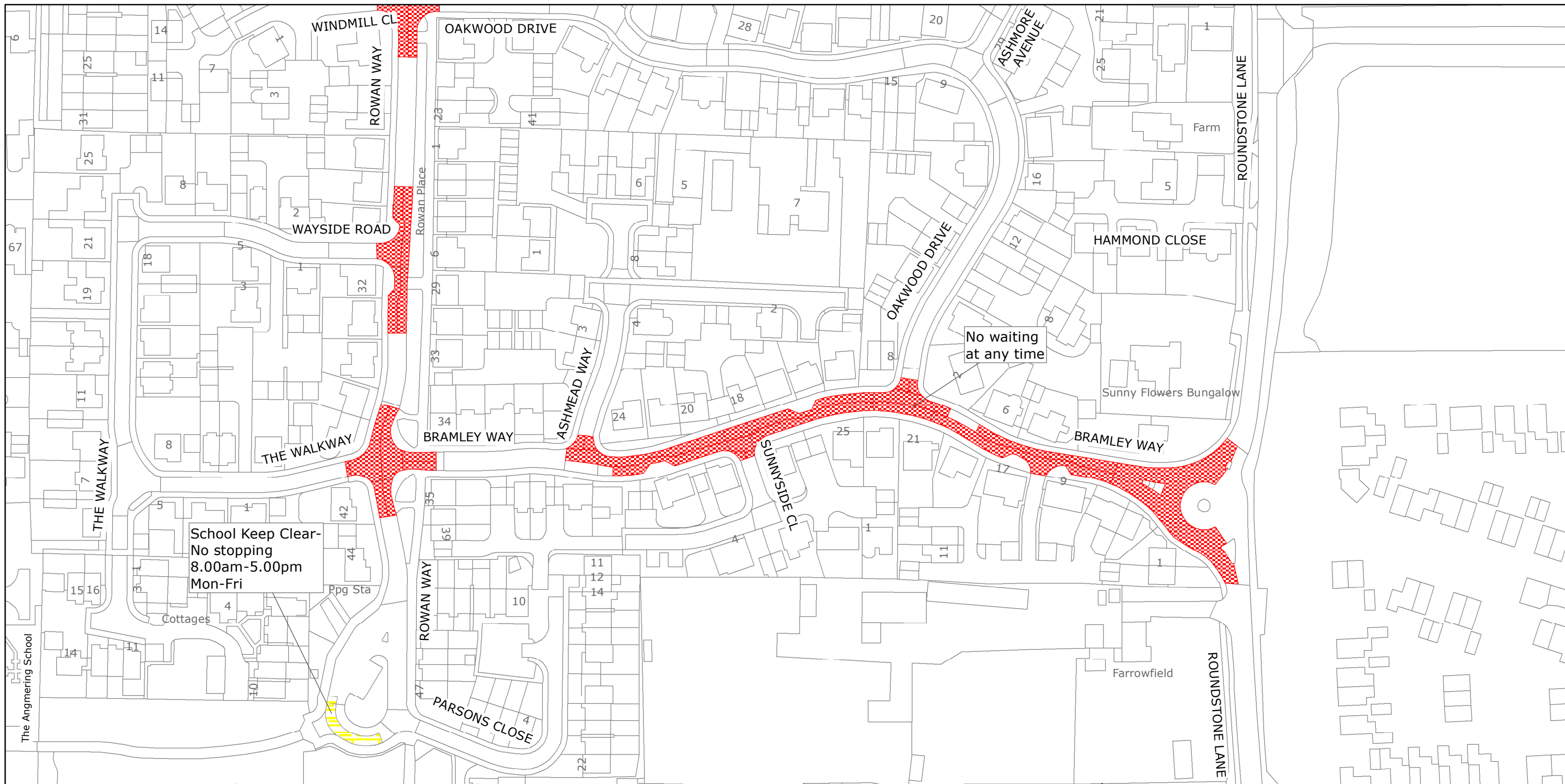

West Sussex County Council  
Highways & Transport  
The Grange  
Tower Street  
Chichester  
West Sussex  
PO19 1RH

ARUN DISTRICT: ANGMERING  
WAITING RESTRICTIONS

Reproduced from or based upon 2017 Ordnance Survey mapping with permission of the Controller of HMSO (c) Crown Copyright reserved.  
Unauthorised reproduction infringes Crown copyright and may lead to prosecution or civil proceedings West Sussex County Council Licence No. 100018485

TILE REF NO:  
TQ0703NWS

SHEET ISSUE NO 2  
SHEET ACTIVE FROM - 10/04/2017



SCALE:  
1:1250  
at A3 size





West Sussex County Council  
Highways & Transport  
The Grange  
Tower Street  
Chichester  
West Sussex  
PO19 1RH

ARUN DISTRICT: FERRING  
WAITING RESTRICTIONS

Reproduced from or based upon 2017 Ordnance Survey mapping with permission of the Controller of HMSO (c) Crown Copyright reserved.  
Unauthorised reproduction infringes Crown copyright and may lead to prosecution or civil proceedings West Sussex County Council Licence No. 100018485

TILE REF NO:  
TQ0902NES

SHEET ISSUE NO 1  
SHEET ACTIVE FROM - 10/04/2017



SCALE:  
1:1250  
at A3 size